

MURRAY COUNTY.

Section 13
 10798 McGraw-Hill Co., Blank Book Manufacturers, St. Paul.

Township 106

Range 39

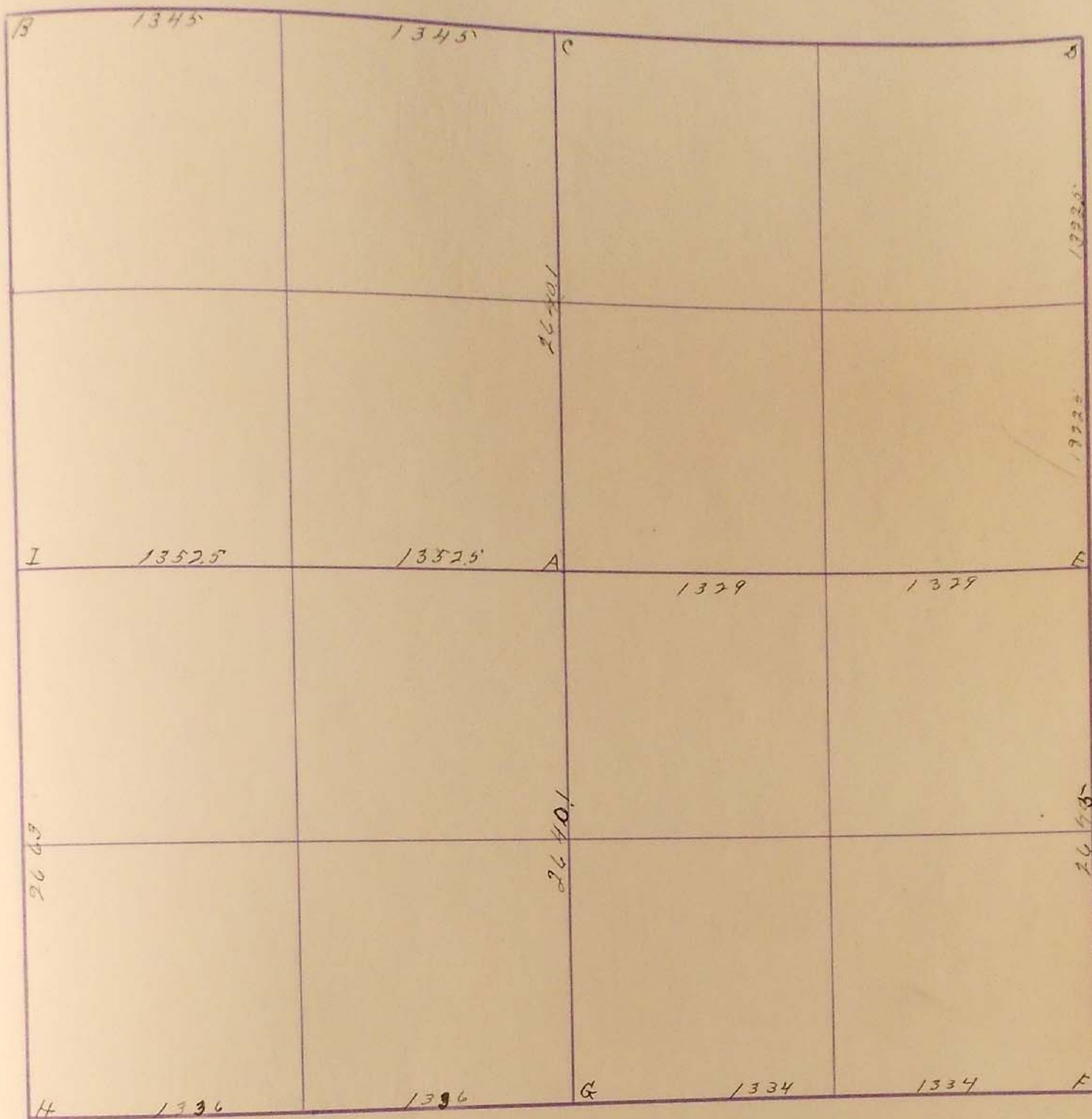

Mar. 2-1914
 Nor. cor. at C & F & G & I. "F" Fence cor. SW. 28.3' F cor SE 37.5'
 Established A. E. H.
 Previous B.
 J. H. Hoolstenroff

- 12
- 13
- 14
- 15
- 16
- 17
- 18
- 19
- 20
- 21
- 22
- 23
- 24
- 25
- 26
- 27
- 28
- 29
- 30
- 31
- 32
- 33
- 34
- 35

SURVEY No. _____

Section 13 Town 106 Range 39



March 2, 1914,

FIELD NOTES.

Gov. cor. at C D F G I
 established R E H
 previous B

JUNE 6 1935
 H. Corner Lost

J W Woolstenorff